

Instructions for fitting and using your ShowerBoB AQOS Digital Shower Meter

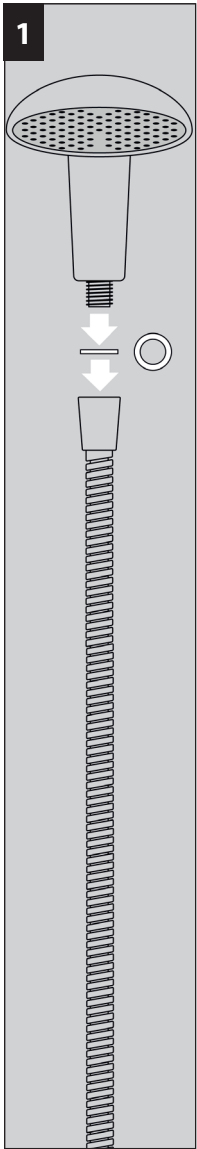

1. Carefully unscrew your existing shower hose from your shower head, making sure you save the rubber washer.

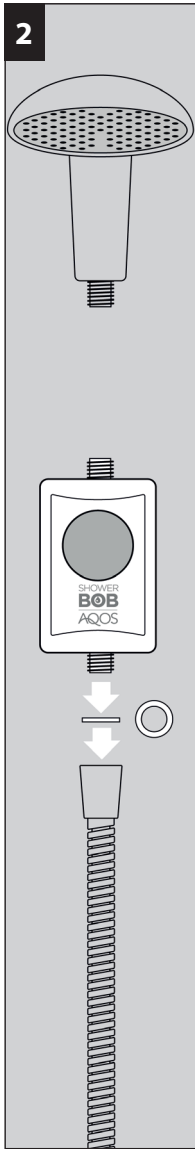

2. Screw your existing shower hose onto the bottom of the AQOS. Ensure the existing rubber washer is in place. If it is damaged or old, we recommend replacing with a new washer.

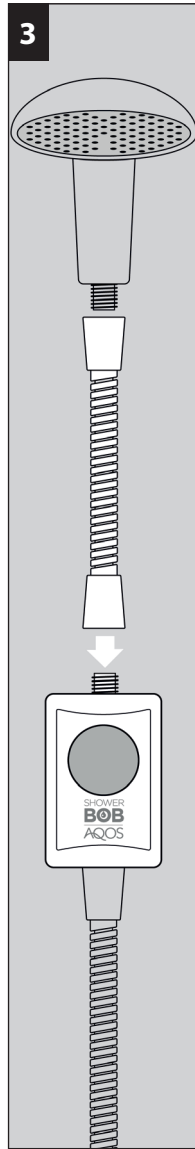

3. Screw the short shower hose supplied onto the top connector of the AQOS, using the end with the additional swivel adaptor. Make sure the rubber washer supplied is in place.

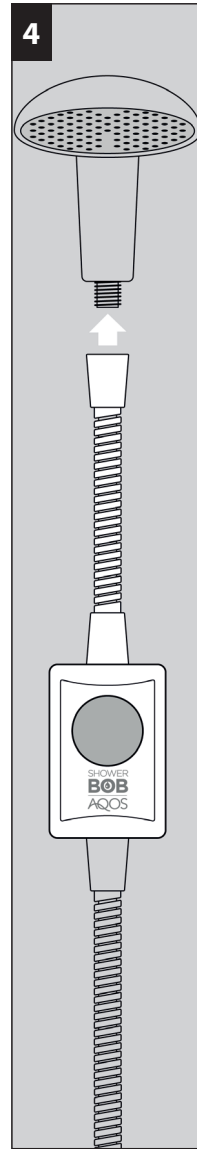

4. Then simply screw the other end of the short hose provided onto your shower head, again ensuring the rubber washer supplied is fitted.

5. With your shower head in place and ready to use, you can swivel the AQOS to face you, so you can clearly see the display.

6. Turn on your shower to test for any leaks and tighten if necessary. Be careful not to over-tighten.

7. The ShowerBoB AQOS uses a water-powered LCD backlit display. **No batteries are needed.** The unit will take a couple of seconds to generate power to the display: This is normal.

8. When you turn off your shower, the AQOS resets for the next user. The meter does not store any information.

Note

Not suitable for electric, power/pumped or digital showers and requires minimum 0.5 bar pressure.

SHOWERBOB
AQOS

Model No: SB-DSM-A
Designed by BoB Products Ltd (UK)
Manufactured in China
WRAS approved

www.showerbob.co.uk



The ShowerBoB AQOS measures:

- Water temperature in Celsius
- Total litres used up to 99.99 litres
- Time with colour change alerts
 - Green (up to 4 minutes or 24 litres @ 6 litres per minute)
 - Orange (up to 5 minutes or 30 litres @ 6 litres per minute)
 - Red (over 5 minutes or 30 litres @ 6 litres per minute)
- Flashing red (over 99.99 litres)