



# How to fit your ShowerBoB shower timer

For ShowerBoB Four, Ring, Twist and Basic

Your ShowerBoB shower timer is designed to provide a guide to the amount of time you spend in the shower. It works as a gentle prompt to help you save water, energy and money.

## Instructions

Watch our how-to-fit video at [www.showerbob.co.uk/installation](http://www.showerbob.co.uk/installation) or follow these simple steps:



1  
Make sure your shower wall surface, tile or glass is clean and dry

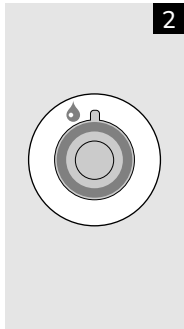

2  
Wet the inside edge of the suction cup

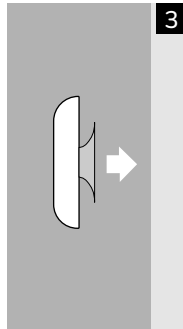

3  
Push securely onto a smooth, untextured surface at a convenient height to see the timer easily

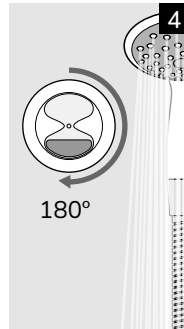

4  
Turn the shower timer 180° at the start of your shower to start the sand running through

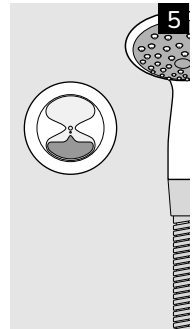

5  
When the sand has run through at 4 minutes, turn your shower off.

Note: Not all surfaces are suitable for suction cups, they may be textured or uneven. Please ensure your surface is suitable.

ShowerBoB (BoB Products Ltd) cannot accept any liability for damage incurred to your fittings or property due to installation or use of this shower timer.

# SHOWERBOB

[www.showerbob.co.uk](http://www.showerbob.co.uk)

