

# How to fit your ShowerBoB AQOS Digital Shower Meter

## Instructions

Watch our how-to-fit video at [www.showerbob.co.uk/installation](http://www.showerbob.co.uk/installation) or follow these simple steps:

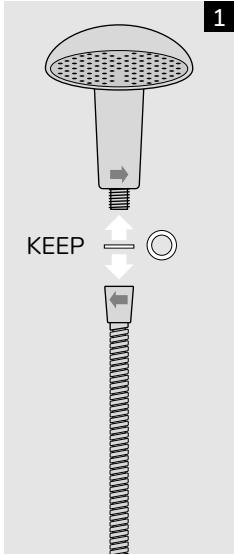

Carefully unscrew your existing shower hose from your shower head, making sure you save the rubber washer.

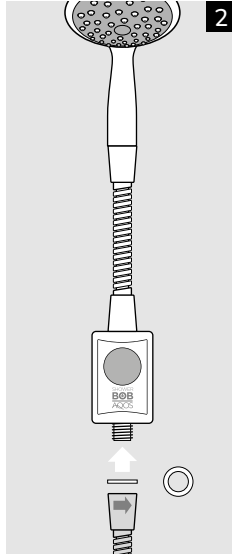

Screw your existing shower hose onto the bottom of the AQOS. Ensure the existing rubber washer is in place.

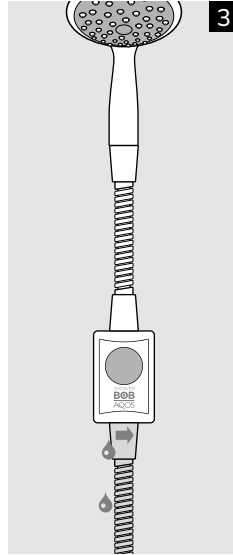

Turn on your shower to test for any leaks and tighten if necessary. Be careful not to over-tighten.

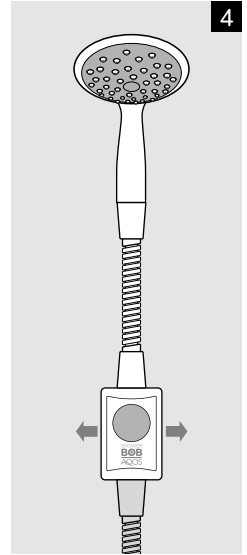

With your shower head in place and ready to use, you can swivel the AQOS to face you, so you can clearly see the display.

SUITABLE for combi boilers and gravity showers.

NOT SUITABLE for electric, multi-jet, digital, power showers, lower pressure, or gravity-fed systems with less than 0.5 bar pressure.

ShowerBoB (BoB Products Ltd) cannot accept any liability for damage incurred to your fittings or property due to installation or use of this shower head.



SHOWER**BOB**  
[www.showerbob.co.uk](http://www.showerbob.co.uk)

